

## BTR Modular (bell) transformer with on-off switch



- △ Safe electrical separation between primary and secondary circuits
- △ Low voltage 8-12-24VAC
- △ 12VA – 24VA
- △ Temperature protection
- △ Short-circuit protection
- △ Extra overload capacity up to 25% within 24hours
- △ On-off switch

## General information

The SEP BTR12 and BTR24 is mainly used as a bell transformer and as continuous power supply for small components. The device has multiple output voltages 8-12-24VAC so that it can be used for different applications. It follows also the rules of safety isolating transformer.

## BTR – (bell) transformer with on-off switch



U1n	U2n	Pn	Width	Article no.	Type	EAN code	Pack.
230V	8-12-24V	12VA	2 MU	2114120012	BTR12	8718959015731	1/5/30
230V	8-12-24V	24VA	3 MI	2114120024	BTR-24	8718959015748	1/4/20



## Certification marks



### General parameters

Suitable for household, utility as well as industrial applications

### Electrical parameters

Article number		2114120012	2114120024
Type		BTR12	BTR24
Tested according		IEC61558-2-6 (safety isolating transformer) IEC61558-2-8 (bell transformer)	
Rated input voltage	U1n	230VAC	
Rated frequency		50/60Hz	
Rated output voltage	U2n	8, 12, 24VAC	
Rated output current	8V	1,5A	3A
	12V	1A	2A
	24V	0,5A	1A
Rated output power	Pn	12VA	24VA
Power loss	Pdis	1,5W	2W
Service period		Continuous	
On/off switch		Yes	
Temperature protection		Yes	
Short-circuit protection		Yes	
Ambient operational temperature		0°C + 40°C (daily average of <35°C)	
Isolation material		PA66	
Flammability class		V0	
Colors		Grey	

### Mechanical parameters

Device width	36mm	54mm
Device height	85mm	
Device depth	64mm	
Mounting	Easy fastening onto 35mm device rail (DIN)	
Degree of protection	IP20	
Minimum cross section solid	0.75 mm <sup>2</sup>	
Maximum cross section solid	6 mm <sup>2</sup>	
Minimum cross section stranded	0.75 mm <sup>2</sup>	
Maximum cross section stranded	4 mm <sup>2</sup>	
Terminals	Screw	
Torque	1.2Nm	
Storage temperature	-25°C + 70°C	
Protection class	II	
Weight	0,356 kg	0,660 kg

## Dimension drawings

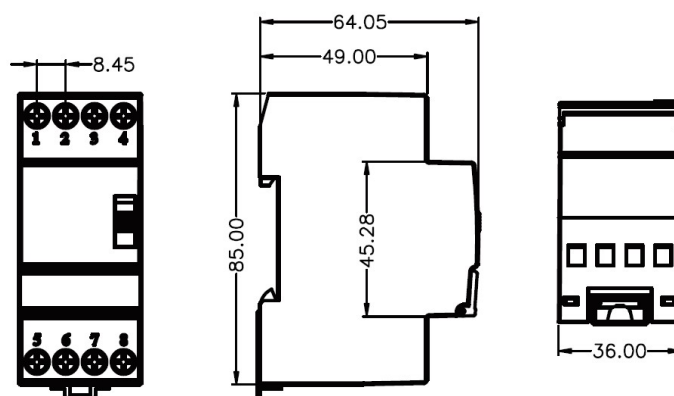

BTR12

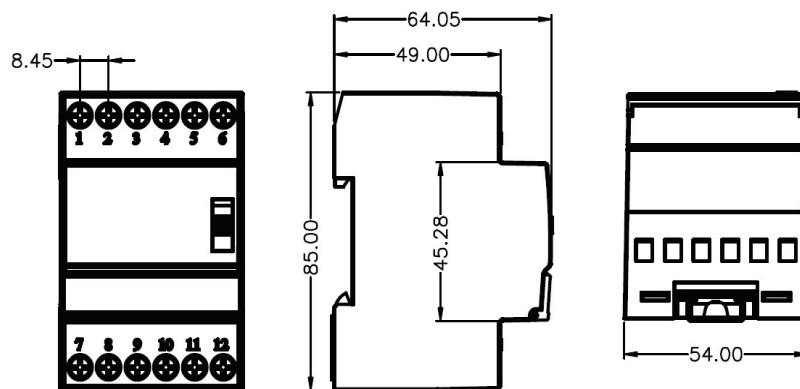

BTR24

## Wiring diagram

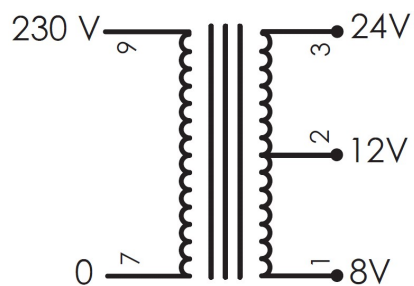

BTR12 and BTR24